

[309] TARALAY 2F (WITH FIX & FREE 100 AND 740 DOUBLE-SIDED ADHESIVE TAPE)



Ambient temperature
Min: 15°C



Substrate temperature
Min: 15°C

All floor and wall coverings should be examined prior to installation for any visible defects. If there are any visible defects, please notify GERFLOR and do not begin installation without its prior approval.

1. AREAS OF APPLICATION

MATERIALS	TARALAY 2F
FLOOR COVERINGS	Taralay Impression Compact/Comfort - Taralay Premium Compact/Comfort
DOUBLE-SIDED ADHESIVE TAPE CONSTRUCTION	Non-migrating removable double-sided solvent-free acrylic adhesive on polyester mesh substrate. Protective paper: Silicone-treated paper Fix & Free 100 (Ref: 058U0001) Width: 100 mm/Length: 50 m/5 m ² Fix & Free 740 (Ref: 058W0001) Width: 740 mm/Length: 25 m/18.5 m ² Storage life: 12 months in original packaging Store in a dry place away from sunlight <ul style="list-style-type: none"> • Storage temperature: between 15 and 30°C • Application temperature: +15°C minimum
UPEC OR EUROPEAN CLASSIFICATION	For use in premises with U4 P3 E2 C2 and U3 P3 E2 C2 ratings, or in European Standard class 34/43 and 33/42 premises
AREA OF USE	Please refer to the Material selection guide in GERFLOR's general catalogue

2. NEW AND RENOVATED SUBSTRATES

PERMITTED SUBSTRATES

CONCRETE FLOOR, PAINTED CONCRETE, LEVELLING CONCRETE	In all cases, apply a levelling compound. Sand, vacuum carefully and apply a primer. Gerflor recommends that you refer to the technical specifications of the primers for instructions.
LIQUID SCREED (ANHYDRITE OR CEMENT) Please refer to the recommendations set out in the technical report when selecting primer.	In all cases, apply a levelling compound. Sand, vacuum carefully and apply a primer. Gerflor recommends that you refer to the technical specifications of the primers for instructions.
TILED SUBSTRATE	Apply a levelling compound and the appropriate primer to avoid the appearance of phantom grouting joints and unevenness.
COMPACT PVC FLOORS	Permitted if the existing compact PVC floor is glued down at all points. Check the weld seams; they must be good quality and must not be concave. Thoroughly clean the existing floor.
VINYL ASBESTOS	Refer to the TARALAY 2F ON VINYL ASBESTOS SUBSTRATE Installation guidelines
INSTALLATION ON FLOORBOARDS, FLOORBOARDS ON JOISTS, FLOATING PARQUET, FLOATING PARTICLE BOARDS, OSB BOARDS, OR PARQUET NAILED ONTO BATTENS WITH VENTILATION OF THE INSIDE FACING	Use 19 mm lining board and a primer.

UNDERFLOOR HEATING

UNDERFLOOR HEATING (floor temperature < 28°C) The regulations require: ≤ 0.15 m ² x ° Kelvin/Watt	Permitted
RADIANT ELECTRIC UNDERFLOOR HEATING The regulations require: ≤ 0.15 m ² x ° Kelvin/Watt	Permitted
LOW TEMPERATURE WATER REVERSIBLE UNDERFLOOR HEATING The regulations require: ≤ 0.13 m ² x ° Kelvin/Watt	Not permitted

SUBSTRATES NOT PERMITTED (NON-EXHAUSTIVE LIST)

PVC FLOORS WITH SOUNDPROOF LAYER (FOAM)
WOODEN SUBSTRATES: FLOATING PARQUET, GLUED PARQUET, FLOATING PARTICLE BOARDS, OSB BOARDS, LAMINATES
LAYING ON SOUNDPROOFING OR INSULATING UNDERLAYER
RUBBER
TEXTILE FLOORING (CARPET)
TILES AND LVT SNAP-TOGETHER PLANKS
LINOLEUM/LINOLEUM WITH BACKING FOAM
RAISED ACCESS FLOORS

IMPORTANT : The information in this document is valid from: 01/06/2018 and is subject to change without notice. Due to continuous technical improvements, before starting any work our customers should check with us that this document is still applicable.

[309] TARALAY 2F (WITH FIX & FREE 100 AND 740 DOUBLE-SIDED ADHESIVE TAPE)

3. LAYING

3.1. LAYING CONDITIONS

The Taralay and the Fix & Free must be stored where they are going to be laid for at least 24 hours before laying (minimum ambient temperature 15 °C). The room temperature must be between 15 and 25°C.

The rolls will be laid flat after the substrate has been prepared and the Fix & Free has been applied.

3.2. PRIMER APPLICATION

PRIMER MUST BE APPLIED TO:

MASONRY SUBSTRATES (flagstones, paving, screed, cement liquid screed in accordance with dtu 53.2) and LEVELLING COMPOUND		TILES	WOOD		ASBESTOS	CALCIUM SULPHATE SCREED
Manufacturer	Reference	Levelling compound mandatory. For applying primer to levelling compound, please refer to the Masonry substrate table.	Manufacturer	Reference	Direct application without primer	Levelling compound mandatory. For applying primer to levelling compound, please refer to the Masonry substrate table
BOSTIK	Primasol R <4,5%		BOSTIK	Primasol R Unidur N		
F BALL	P121 <4,5% F78 < 7% Seal Concrete <4,5%		F BALL			
HB FULLER	Tec 049 <4,5%		HB FULLER	Tec 049		
MAPEI	Eco Prim T <4,5%		MAPEI	EcoPrim T		

Other primers exist that are recommended by the glue manufacturers.
Gerflor recommends that you refer only to the technical specifications of these primers for instructions.

When applying a primer, use a primer recommended by Gerflor.

- Remove dust from the substrate with an industrial vacuum cleaner.
- Shake the primer container.
- Apply a single, thin, even coat of primer in a criss-cross pattern with a roller, following the manufacturer's instructions. Avoid forming puddles or drips. On wood-based materials, apply two coats with the roller.
- The primer must be left to dry for at least 2 hours, with the room well ventilated. The primer must be completely dry. The drying time depends on the substrate, weather conditions and ventilation.
- While they are acclimatising, the Fix & Free 100 and 740 must not be resting on the primer.



3.3. APPLYING FIX & FREE DOUBLE-SIDED ADHESIVE TAPE

3.3.1. Applying Fix & Free 100

- First of all, test the bond of the double-sided adhesive tape when it has been smoothed.
- Apply Fix & Free 100 along the walls and across thresholds, following the line of the walls, for improved bonding around the edges and in difficult to reach areas.
- Do not remove the protective paper yet.
- The Fix & Free 100 strips must be arranged side-by-side, not overlapping.

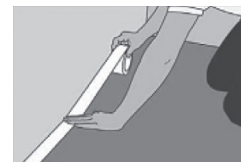

3.3.2. Applying Fix & Free 740

- Unroll the Fix & Free 740 double-sided adhesive tape in the direction of laying of the new floor covering. If there are two layers of adhesive overlapping, cut off the excess with a straight-blade knife without damaging the substrate (maximum gap between two strips of adhesive: 5 mm).
- Smooth by hand or with a wide flexible mop and then cut the overlapping section with a straight-blade knife. Take care not to damage the substrate.
- Only apply Fix & Free to an area of floor that can be covered in the same day.

Note: If you don't use the whole roll, replace the protective paper and put the roll back in the box.

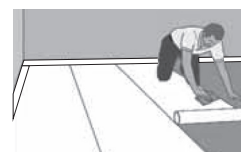

3.4. LAYING THE FLOOR COVERING

3.4.1. Laying direction

Floor coverings must be laid with the rolls running in alternating directions APART FROM imitation coverings (wood, etc.). Cf. Installation Guidelines 201, Direction of laying floor coverings. Imitation floor coverings are supplied without a joint effect on the selvages.

The last plank of the imitation design (wood, etc.) is slightly wider to enable double cutting if necessary.

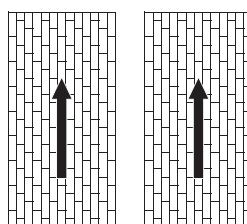

Direction of laying - imitation floor covering (wood, etc.)

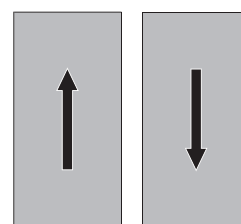

Direction of laying - other floor coverings

3.4.2. Positioning

As far as possible, and taking account of the roll width, joints between rolls must be situated away from anticipated areas of heavy traffic (for example, in front of doors).

- The rolls must be oriented towards the wall with the main window, or lengthwise, with a 1 cm gap between rolls.
- In corridors, rolls should be laid in the direction of the main traffic flow unless specified otherwise in the Contract-Specific Documents.

FLOORS IN BUILDINGS

[309] TARALAY 2F (WITH FIX & FREE 100 AND 740 DOUBLE-SIDED ADHESIVE TAPE)

3.4.3. Laying

- Move the rolls closer together, leaving a 0.5 to 0.8 mm gap between them (the thickness of a credit card).

There are several options:

- 1 Fold the floor covering half way back on itself lengthwise.
 - 2 Roll the floor covering half way back on itself lengthwise.
 - 3 Fold the floor covering half way back on itself widthwise.
- Carefully cut the protective paper with a straight blade.
 - Fold the protective paper back 10 cm under the second part of the floor covering (form a tongue).
 - Remove the protective paper from the Fix & Free double-sided adhesive tape by pulling it back straight and flat, as the floor covering is laid.
 - Roll up the protective paper so that you don't slip on it.

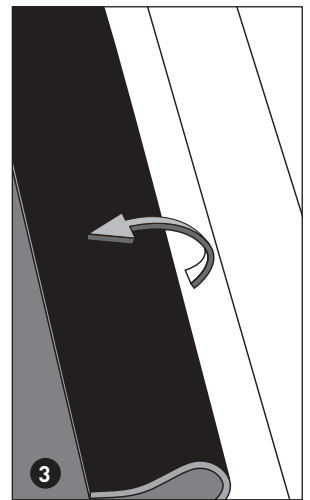
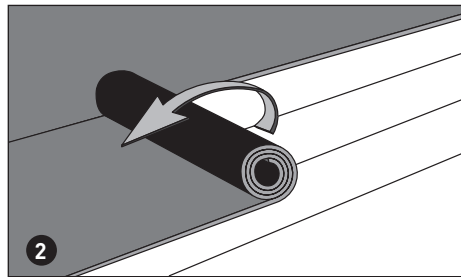
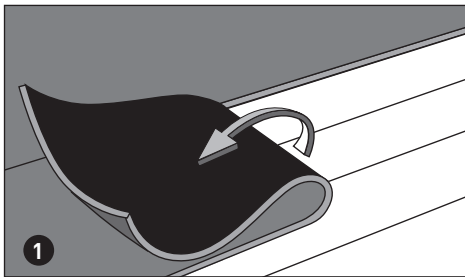
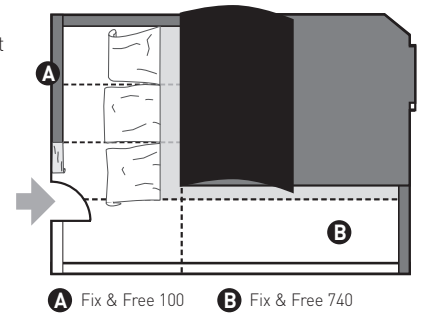

3.4.4. LAYING FLEXIBLE FLOOR COVERINGS IN ROLLS

When floor coverings in rolls are laid on double-sided adhesive tape, they must be smoothed as each roll is applied to prevent the appearance of bulges.

- Apply the first half of the floor covering, smoothing as you go, in order to avoid air bubbles.
- Start smoothing from the middle of the roll, pushing the air out towards the edges.
- Fold down the second half of the floor covering.
- Using the tongue created previously, remove the rest of the protective paper.
- Gradually lay the floor covering, smooth and trim the edges to fit.

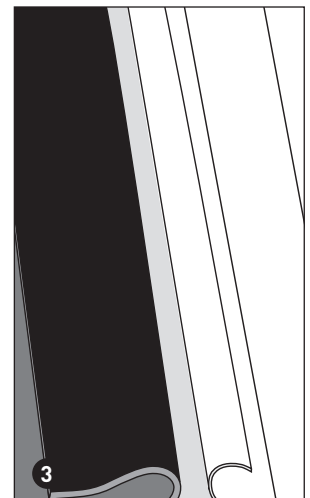
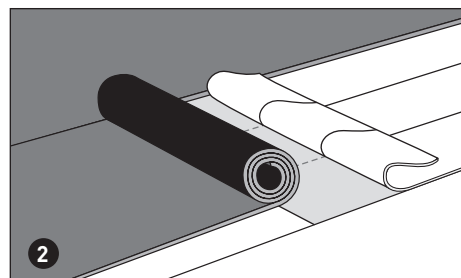
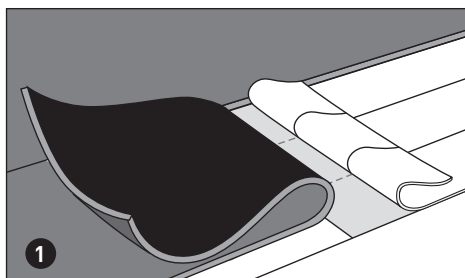
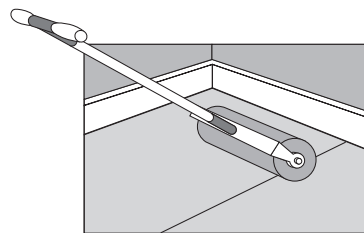

[309] TARALAY 2F (WITH FIX & FREE 100 AND 740 DOUBLE-SIDED ADHESIVE TAPE)

3.4.5. FINAL SMOOTHING

The aim of final smoothing is to ensure correct transfer of the adhesive coat from the double-sided tape to the back of the material.

Each roll is smoothed as soon as it has been laid down. First, start from the middle of the roll, lengthways and then out towards the edges.

Smooth the flooring using a 30 kg or 50 kg pressure roller.

Pressure roller ref.: 193160 by ROMUS.

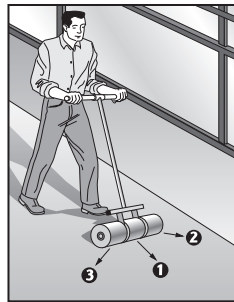

Smoothing with a roller

Smoothing with a roller has a significant impact on the performance of the material over time. Concentrate on the edges and/or on areas that will be less walked on.

3.6. TRIMMING

Different possible scenarios:

3.6.1. Edge trimming before installation of skirting

Caulking:

This method provides improved watertight sealing around the edges and prevents the ingress of water from cleaning, flooding or adjacent rooms (e.g. tiled bathrooms).

We recommend this method, which consists of trimming the floor covering, leaving a 3 to 5 mm gap between the floor covering and the wall.

Fill the gap with a polyurethane or MS polymer sealant. Cover the gap with skirting.

This method hides the sealant.

3.6.2. Edge trimming along existing skirting

Caulking:

This method provides improved watertight sealing around the edges and prevents the ingress of water from cleaning, flooding or adjacent rooms (e.g. tiled bathrooms).

We recommend this method, which consists of trimming the floor covering, leaving a 1 to 2 mm gap between the floor covering and the skirting.

Fill the gap with a polyurethane or MS polymer sealant. This method leaves the sealant showing.

3.6.3. Coving on Cove former or Full cove former

Apply Romtack double-sided adhesive tape by ROMUS to the entire coving portion. There is no need to apply glue to Taralay 2F before it is used to form coving.

Internal corner: Apply the floor covering and cut at 45°

External corner: V-shaped cut (butterfly) method:

For welding on coving, please refer to the Installation Guidelines [502] available on the Gerflor web site.

Fix & Free 100 and 740 are not suitable for coving application. The adhesive coat weight does not provide sufficient tack.

↓ Coving

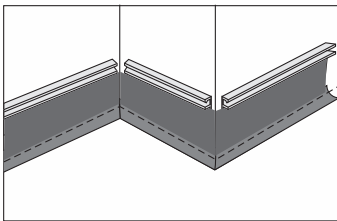

Apply double-sided adhesive tape to the cove former, the wall and the base of the capping strip

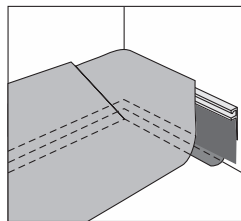

Internal corner: Apply the floor covering and cut at 45°

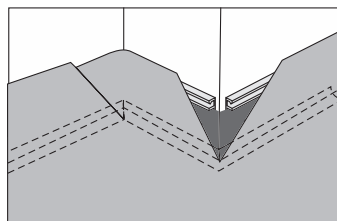

External corner: If necessary, apply double-sided adhesive tape such as Romtack by ROMUS to the back of the butterfly

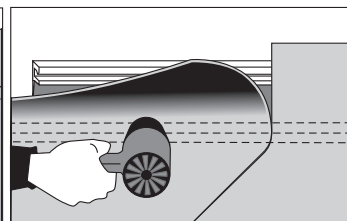

Apply the material to the cove former, and heat if necessary

3.7. HOT WELDING

For hot welding, please refer to Installation Guidelines [501], available on the Gerflor web site.

4. TIME BEFORE FIRST USE

If the laying conditions have been complied with and the floor covering has been smoothed correctly, the room can be fitted out and used immediately after installation.

5. FITTINGS OR FURNITURE

- Ensure that end caps on table and chair feet, etc., are suitable for flexible floor coverings (PVC, Linoleum).
- We recommend flat end caps without any pattern and with the surface in full contact with the floor covering (no conical end caps).
- Do not allow rubber feet to be used on furniture.
- Ensure that office chairs have type H castors compliant with EN 12529

